

LED MODULE INSTALLATION GUIDE

LED MODULE INSTALLATION GUIDE

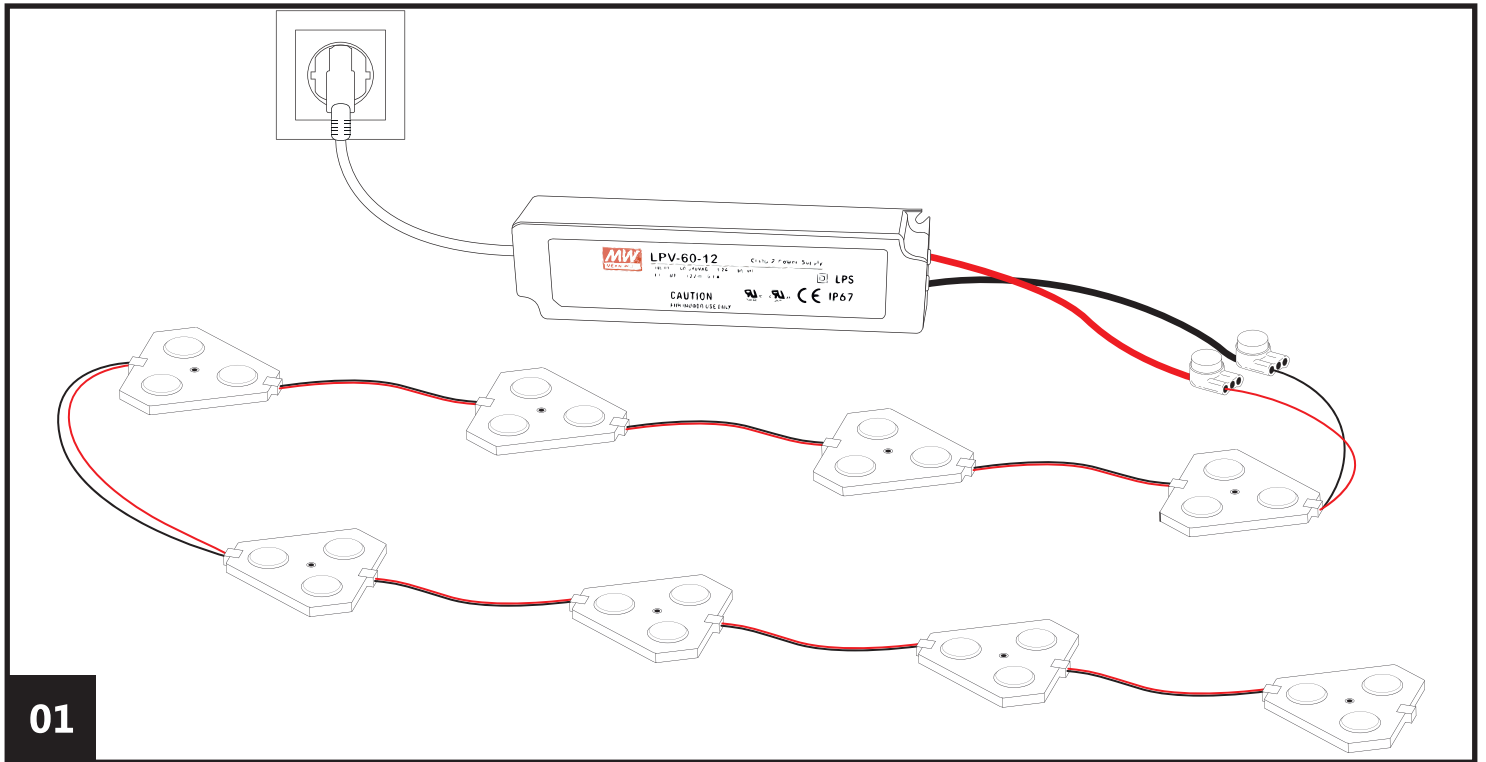

Before installation, check the entire chain of LED modules for light intensity and color consistency.

LED MODULE INSTALLATION GUIDE

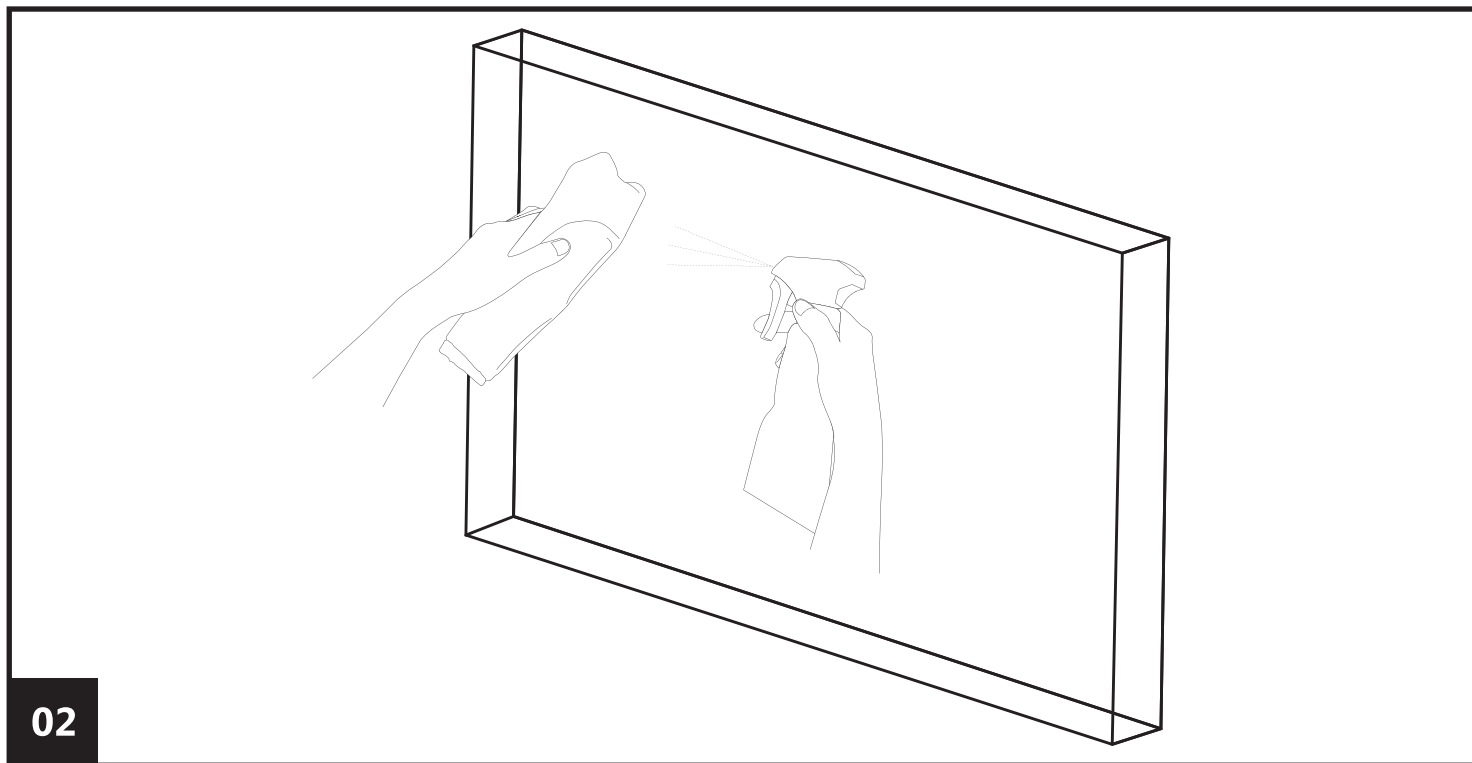

Clean the surface of the modules installation with degreasing agent.

LED MODULE INSTALLATION GUIDE

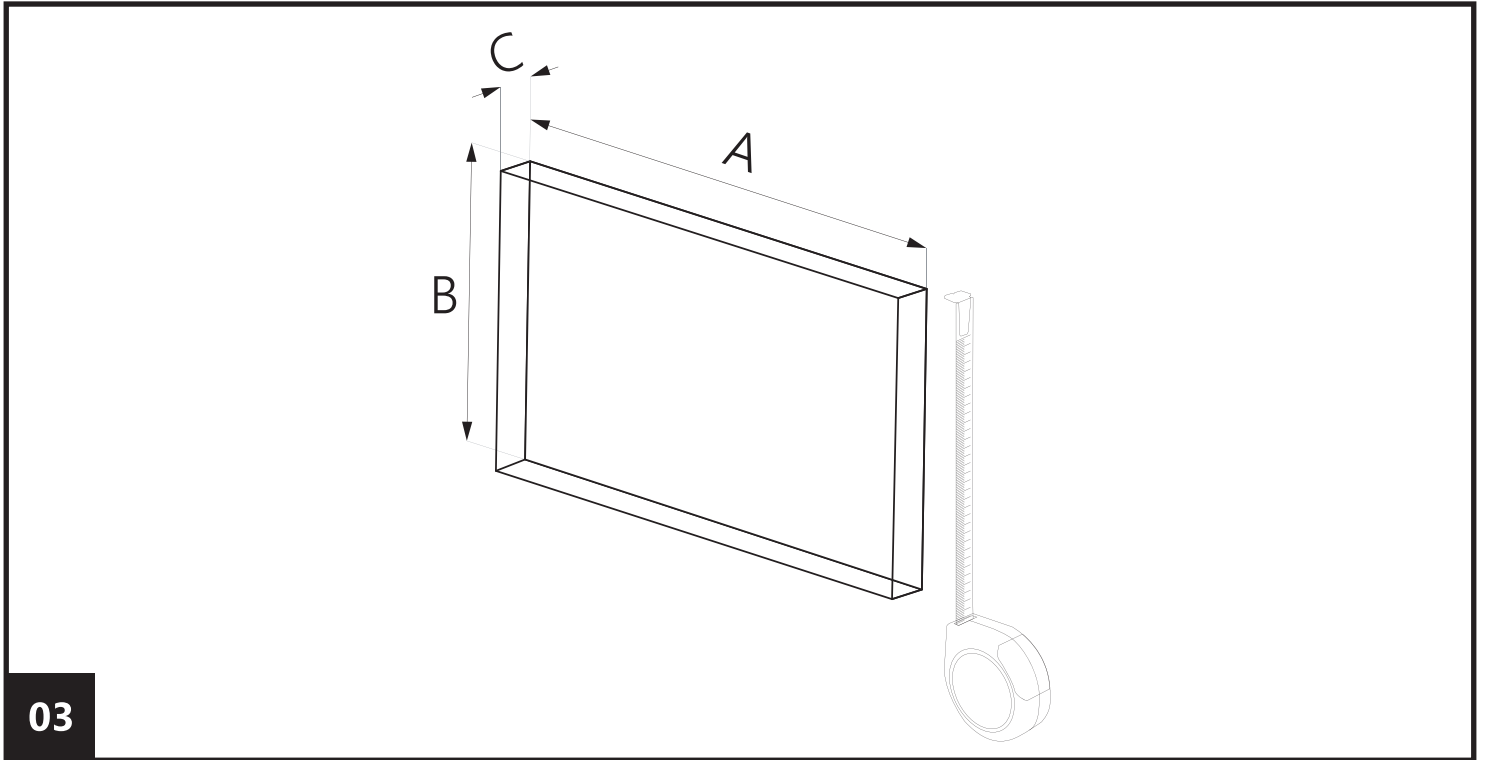

Set the right module spacing. Consider the size of the box or channel letter (mainly depth), the front face material type and desired lighting effect. If it is necessary, you can wrap the wires and dense the LED modules pitch.

LED MODULE INSTALLATION GUIDE

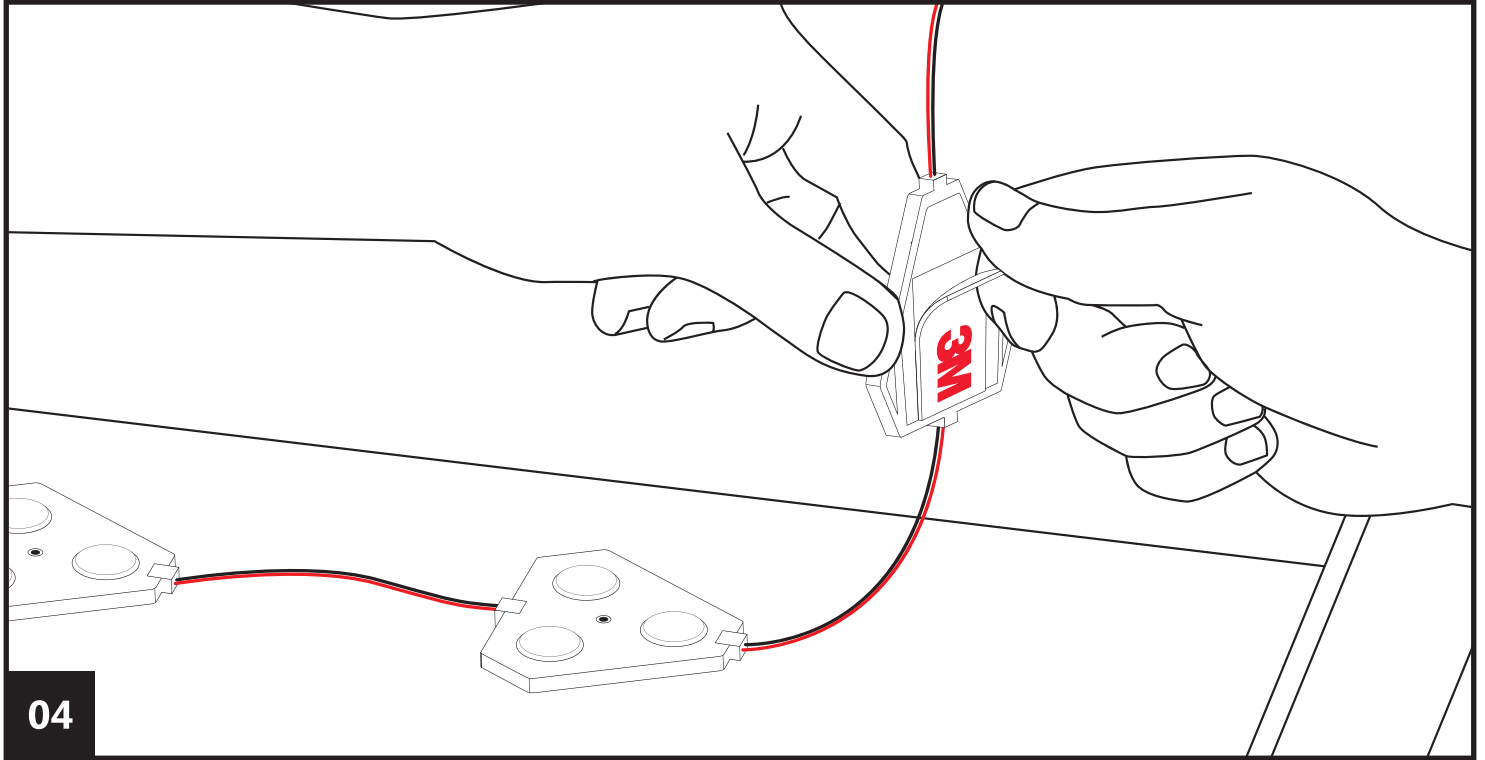

Arrange the modules.

NOTE: The adhesive tape is for auxiliary assembly only.

LED MODULE INSTALLATION GUIDE

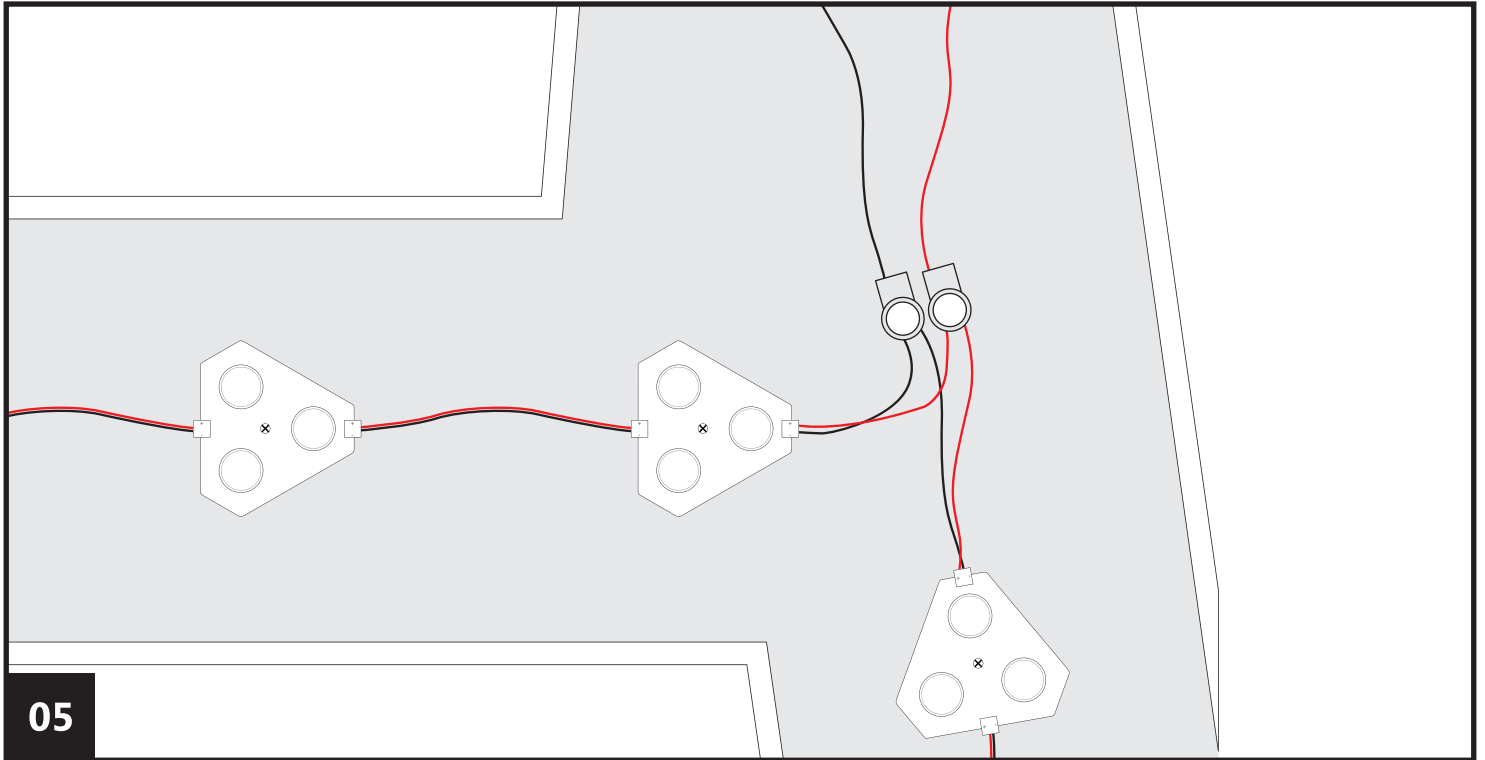

Connect the LED modules to each other by connectors compliant with IP67.

NOTE: Be sure not to exceed the permitted number of LED modules in the chain.

LED MODULE INSTALLATION GUIDE

06

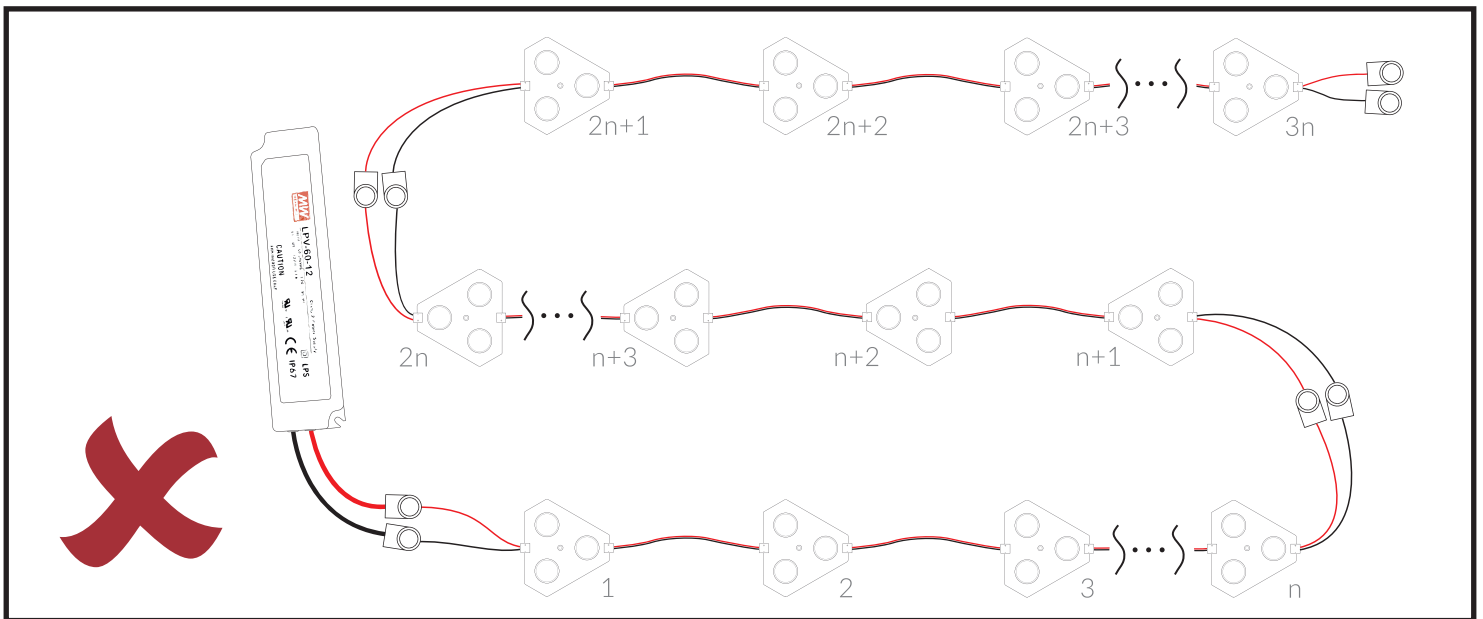
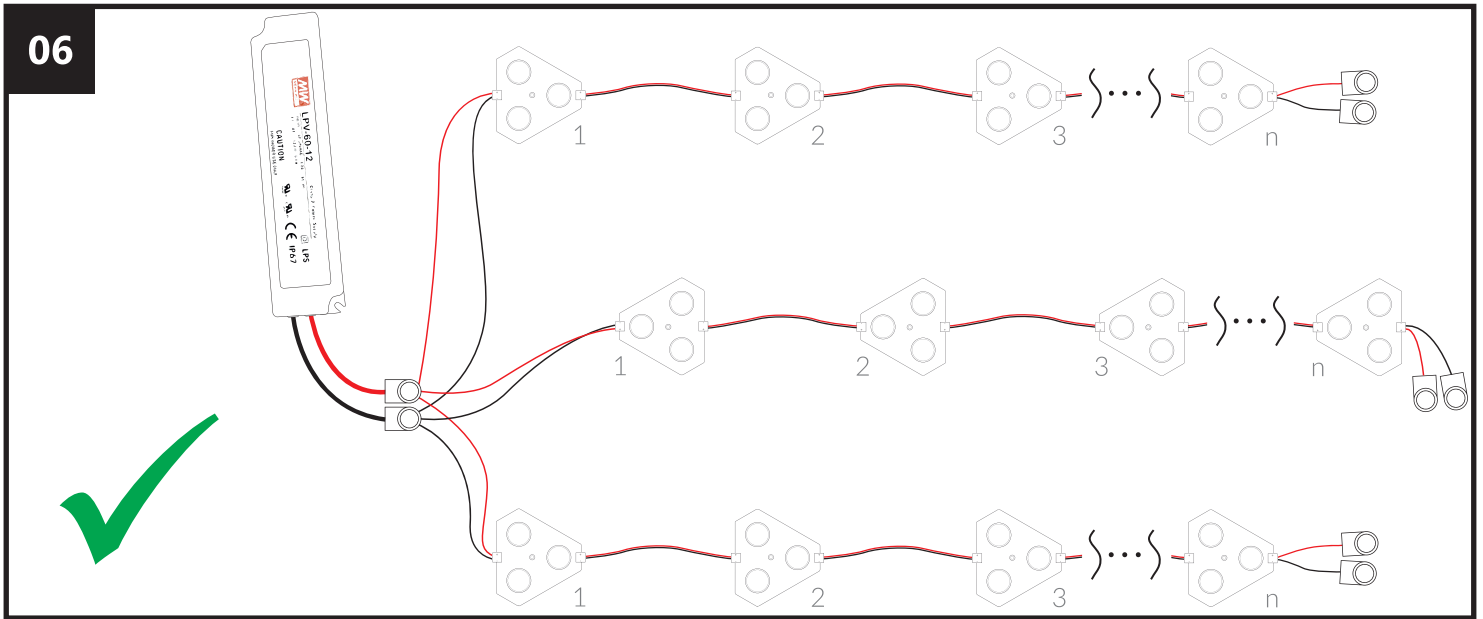

n – maximum allowed number of modules in a chain

Correct (parallel) vs. incorrect (series) connection of several module chains

Connect the module circuitry to the proper power supply unit. **NOTE: Refer to the product datasheet for maximum allowed number of modules in a chain.**

LED MODULE INSTALLATION GUIDE

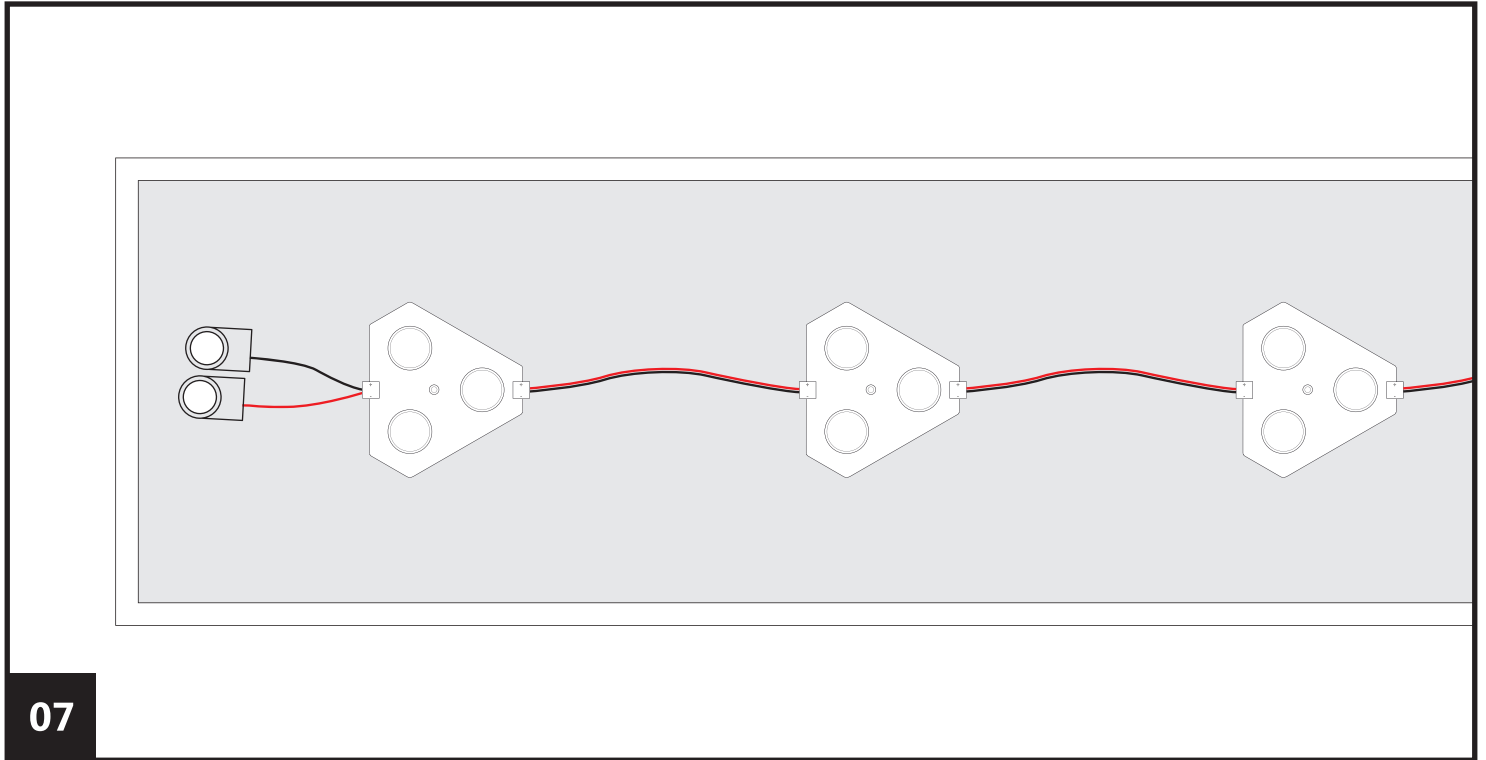

Isolate the free wires with IP67 certified connector.

NOTE: Check the cables for short circuits.

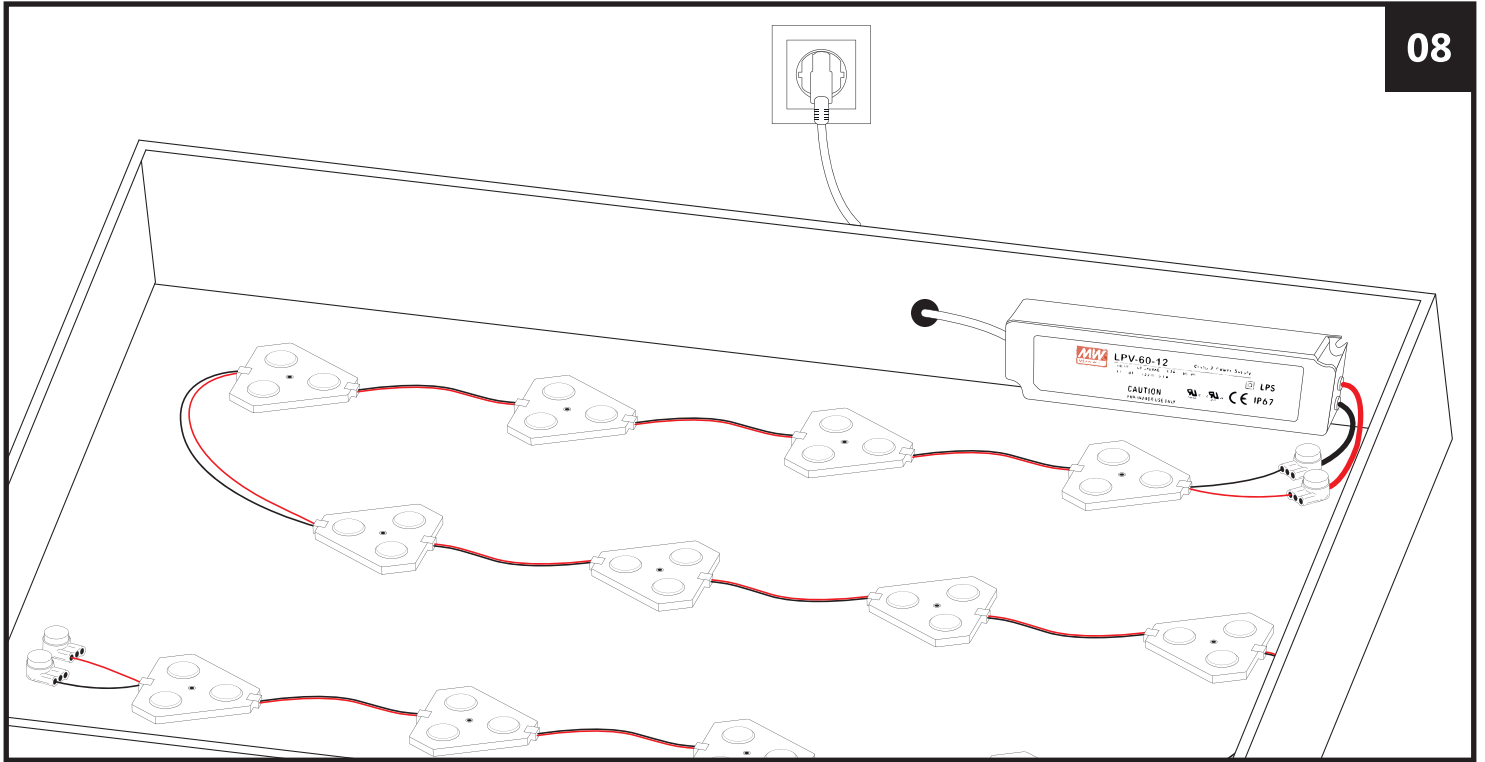

Switch on the power and verify the lighting effect.

LED MODULE INSTALLATION GUIDE

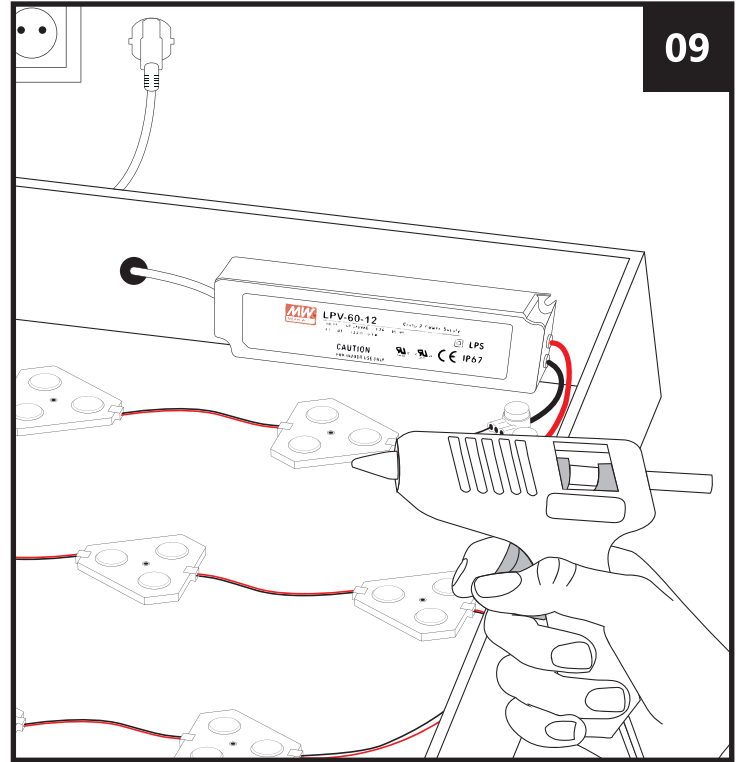
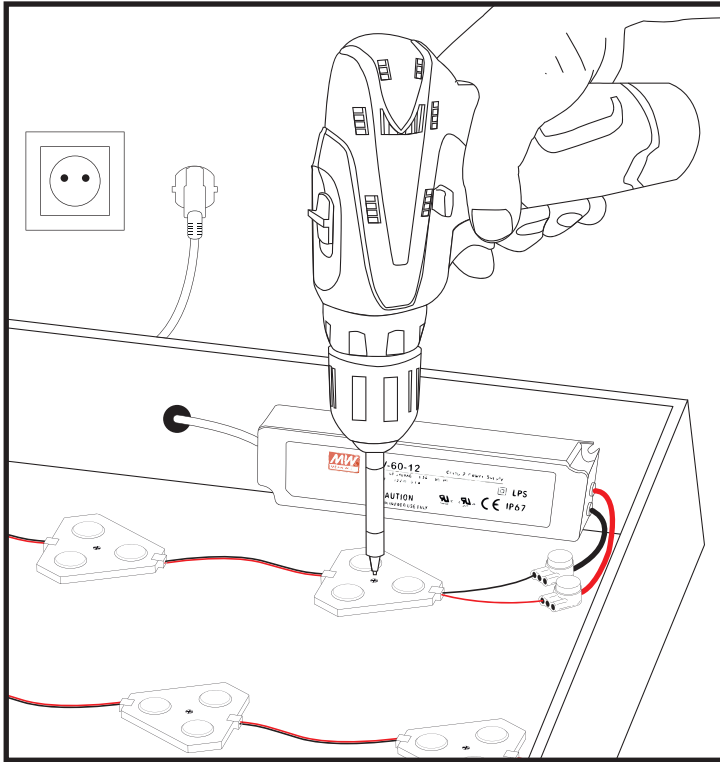

Fasten the modules and the wires permanently by screwing, riveting or the special glue.

NOTE: Make sure your system is unplugged.

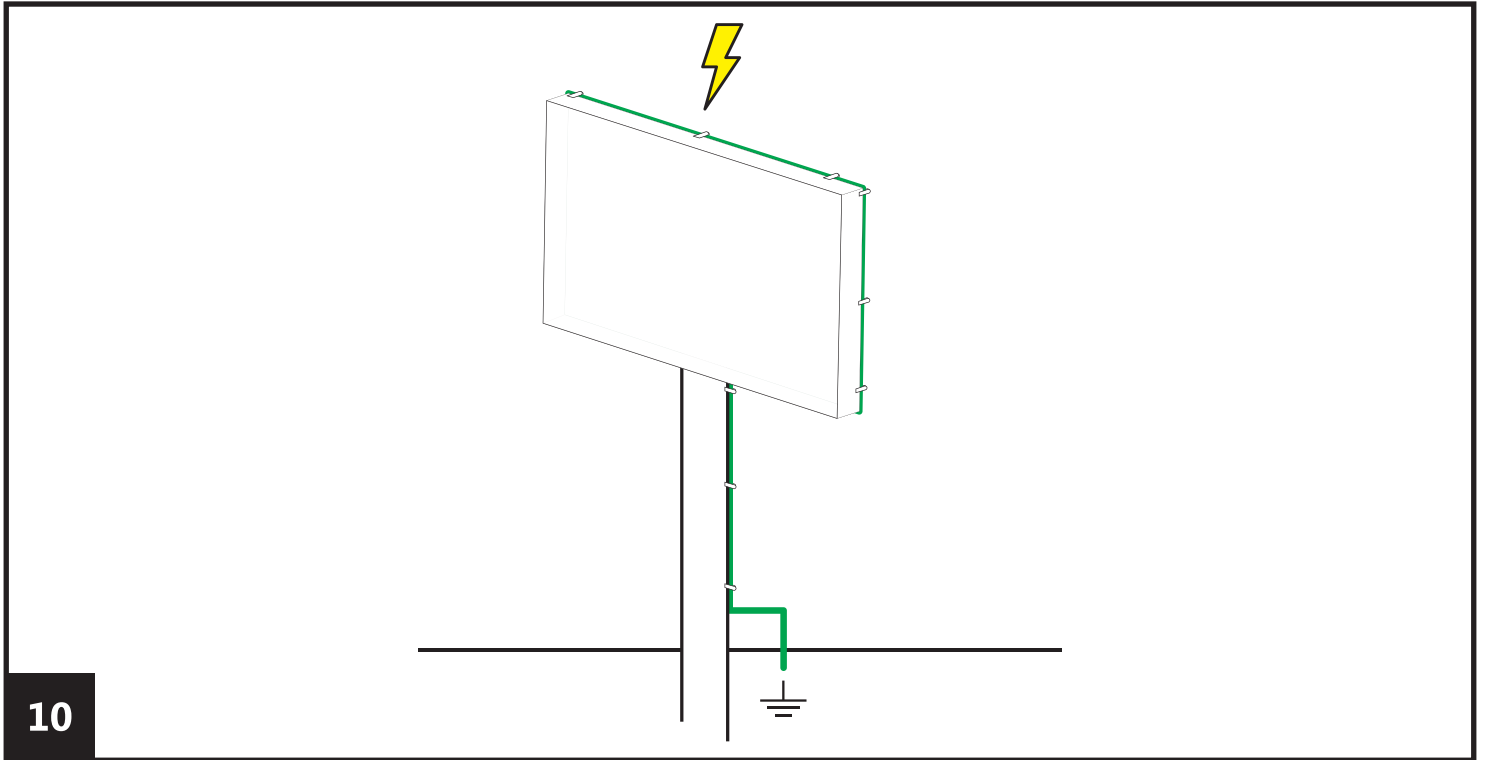

The light box / channel letter body shall be grounded.

NOTE: Fail to ground the body might endanger the ESD shock which leads to module destruction.